

NORTHWEST PIPE FITTINGS, INC
OF SCOTTSBLUFF, NE



REPAIR CLAMPS & COUPLINGS

COMPUTER #	DESCRIPTION	
	REDI CLAMPS	
212-6680	4" 500-07-0474 REP CPLG 4.74-5.14	
212-6700	4" 500-12-474 REP CPL 4.74-5.14	
212-6705	4" 500-12-0445 REP CPLG 4.45-4.87	
212-6720	4" 500-15-474 REP CPL 4.74-5.14	
212-6701	6" 500-07-0684 REP CPLG 6.84-7.24	
212-6702	6" 500-10-0655 REP CPLG 6.55-6.97	
212-6703	6" 500-12-0684 REP CPLG 6.84-7.24	
212-6722	6" 500-15-684 REP CPL 6.84-7.24	
212-6706	8" 500-15-0899 REP CPLG 8.99-9.39	
212-6704	8" 500-12-899 REP CLP 8.99-9.39	



COMPUTER #	DESCRIPTION	
	DRESSER COUPLINGS	
212-9790	4" MAXI-RANGE COUPLING 4.46-5.60	
212-9792	6" MAXI-RANGE COUPLING 6.54-7.65	
212-9794	8" MAXI-RANGE COUPLING 8.54-9.85	
212-9796	10" MAXI-RANGE COUPLING 10.65-12.20	
212-9798	12" MAXI-RANGE COUPLING 12.70-14.41	





REPAIR CLAMPS & COUPLINGS

COMPUTER #	DESCRIPTION	
	DRESSER COUPLINGS	
222-6574	441-00000510-900 4" SMITH-BLAIR OMNI COUPLING	
222-6582	441-00000722-900 6" SMITH-BLAIR OMNI COUPLING	
222-6590	441-00000945-900 8" SMITH-BLAIR OMNI COUPLING	
222-6633	441-00001160-900 10" SMITH-BLAIR OMNI COUPLING	
222-6675	441-00001350-900 12" SMITH-BLAIR OMNI COUPLING	



441
Cast Straight Couplings
Cast Transition Couplings
2" through 16"

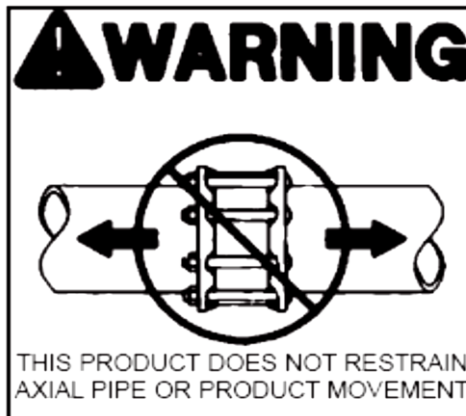
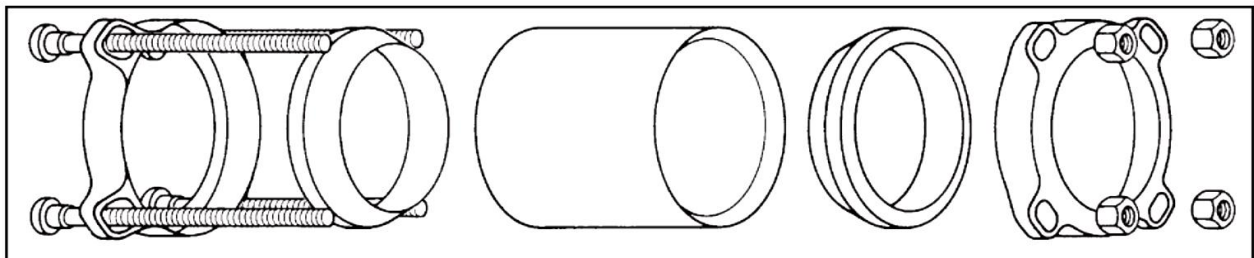

WWW.SMITHBLAIR.COM